

# SIV400

ISO-1

Solenoid / Pneumatic Valves

- 5/2, 5/3
- 40mm Body Width
- 30mm CNOMO PILOT
- Sub-Base Mounting Type
- Transition Flow 1600ℓ/min (5bar)

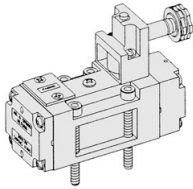

SIV411-IP-

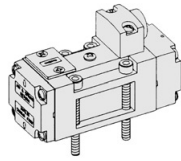

SIP411

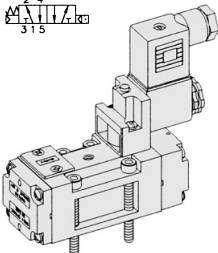

SIV411-EP-SC2-CN2-\*\*-

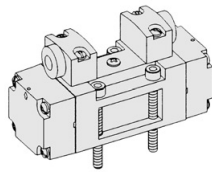

SIP420

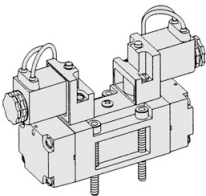

SIV420-IP-SG2-\*\*-

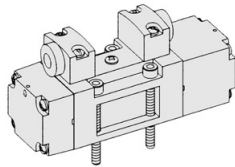

SIP433

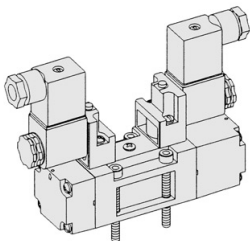

SIV433-IP-SC2-CN2-\*\*-

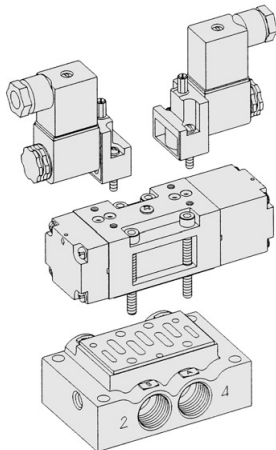

\*\* : Voltage Selection (see page 62)

## SPECIFICATION

ITEM	SERIES	SOLENOID, PNEUMATIC	
	FUNCTION	5 Port 2 Position	5 Port 3 Position
Fluids		Compressed Air & Inert Gases	
Pressure(bar)		1.5~10.0	2.0~10.0
Eff. Sectional Area(mm <sup>2</sup> )-5bar		30.0	25.0
Ambient & Fluid Temp.		5~60°C (41~140°F)	
Response Time(5bar)		30ms or Less	40ms or Less
Max. Working Frequency		3c/sec	1c/sec
Lubrication		Not Required(Use ISO VG32 #)	
Manual Override		Push Button(Standard), Lever Lock(Option)	
Coil Insulation Class		F-Class or Equivalent	
Permissible Voltage Variation		±10% of Rated Voltage	
Off Min. Residual Voltage		AC:20% or Less / DC:10% or Less	
Power Consumption		Holding-AC:5.5VA(60Hz) / DC:2.5W	

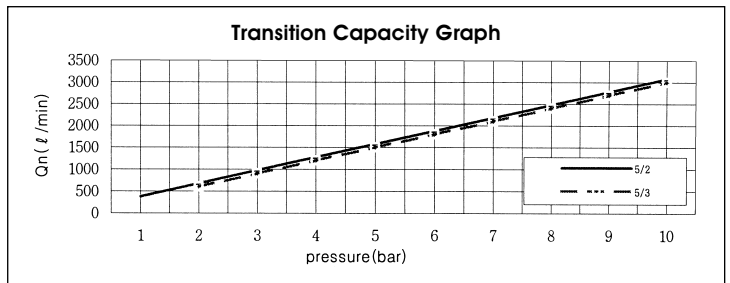

- ### The Material of Parts
- Valve Body : Die-Cast Aluminium
  - Spool : Aluminium
  - Seals : NBR
  - Spring : Stainless
  - Cap : Zinc Pressure Die-Cast
  - Pilot Parts : Glass Filled Nylon
  - Armature : Stainless Steel
  - Armature Seals : Viton

\* The specification on each item can be amended without any prenotice to improve a performance.  
 \* The specification on each item can be different from actual specification.

## ORDERING NO.

**SIV4 1 1 - I P - SC2 - CN2 - A2**

Valve Series	Function	Return Method	Int/Ext. Pilot	Manual Operator	Solenoid Coil Type	Connector Type	Voltage							
<b>SIV4 :</b> Solenoid Valve	0	None	0	None	0	None	0							
	1	5/2 Single	1	Air + Spring	I	Internal Pilot	P	Push Non-Locking	SC2	3 Pin Connector Coil	CN2	Normal Connector	A2	AC 220V
	2	5/2 Double	2	Air	E	External Pilot	P	Push Non-Locking	SG2	Grommet/Flying Leads	CD2	Connector With LED	A1	AC 110V
<b>SIP4 :</b> Pneumatic Valve	3	5/3 Closed Center	3	Spring	L	Lever Locking	L	Lever Locking	SD2	Grommet/Flying Leads With LED	CZ2	Connector With LED & Surge Suppressor	A4	AC 24V
	4	5/3 Open Center											D4	DC 24V
	5	5/3 Pressure Center											D2	DC 12V

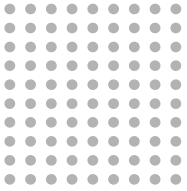

# Solenoid & Pilot Actuated Spool Valves

## 40mm Body Width

### 5Port 2Position Solenoid Valve

Single Solenoid  
SIV411-IP-SD2-\*\*\*



External Pilot  
SIV411-EP-SD2-\*\*\*

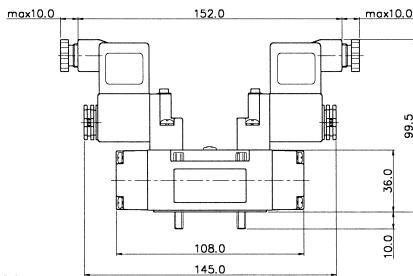
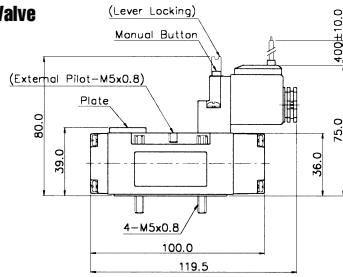

Double Solenoid  
SIV420-IP-SC2-CN2-\*\*\*

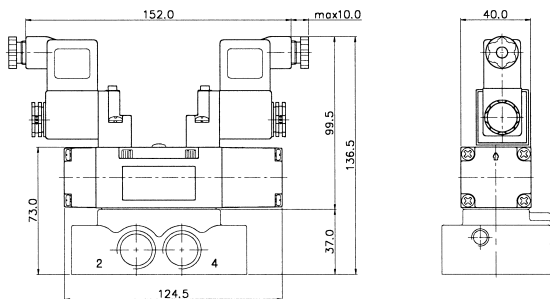
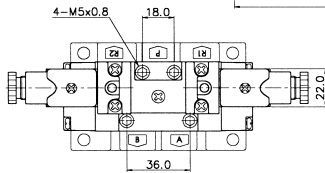

### 5Port 3Position Solenoid Valve

Closed Center  
SIV433-IP-SC2-CN2-\*\*\*

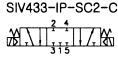

Exhaust Center  
SIV443-IP-SC2-CN2-\*\*\*

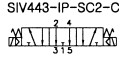

Pressure Center  
SIV453-IP-SC2-CN2-\*\*\*

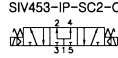

### 5Port 2Position Pneumatic Valve

Single Pneumatic  
SIP411

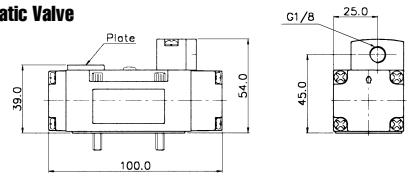
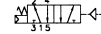

Double Pneumatic  
SIP420

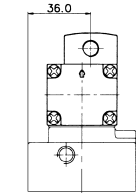
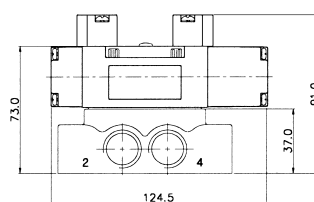
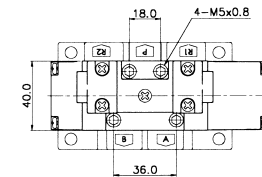
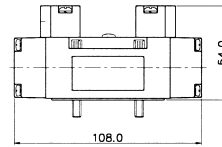
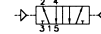

### 5Port 3Position Pneumatic Valve

Closed Center  
SIP433

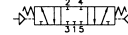

Exhaust Center  
SIP443

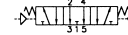

Pressure Center  
SIP453

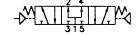

### Sub Base Ordering Code

SIB4 1 - S				
Base Series	Port & Thread	Function		
SIB4 SIV400 Solenoid Valve	0	None	S	Single Station Sub Base, Without Pilot Ports
	1	G 1/4	SP	Single Station Sub Base, With Pilot Ports
	2	G 3/8		
	3	G 1/2		
	6	NPT 1/4		
	7	NPT 3/8		
	8	NPT 1/2		

## SIB40 SINGLE SUB BASE

(SIV400 Solenoid & Pneumatic Valve Use Sub Base)

### Single Station Sub Base Dimension

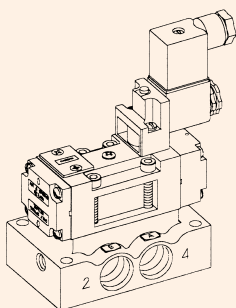

Sub Base Gasket  
(Material: NBR)

Sub Base  
(Material: Al)

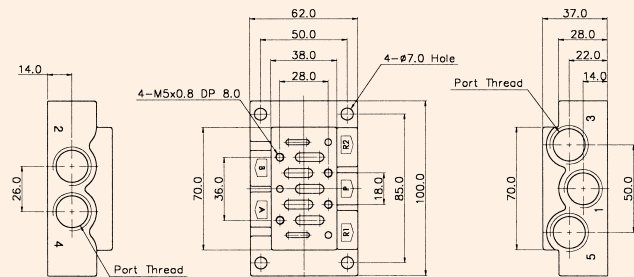
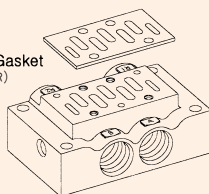

### Port Thread

MODEL	A(4),B(2)	P(1)	R(5),R2(3)
SIB41-S(P)	G 1/4	G 1/4	G 3/8
SIB42-S(P)	G 3/8	G 3/8	G 3/8
SIB43-S(P)	G 1/2	G 1/2	G 1/2